

*Est. 1985*

**ALBION<sup>®</sup>**

SADDLEMAKERS

# SADDLE RANGE

SPECIFICATIONS 2024



[www.albionsaddlemakers.co.uk](http://www.albionsaddlemakers.co.uk)

# CONTENTS

---

CUSTOMISATION INDEX .....	3
DRESSAGE RANGE .....	10
UNITY DRESSAGE .....	12
REVELATION RED LABEL DRESSAGE .....	13
FABRENTO .....	14
SLK M3 ROYALE .....	15
SLK MONO .....	16
SLK DUAL .....	17
K3 DRESSAGE .....	18
K2 DRESSAGE .....	19
JUMP/ GP RANGE .....	21
FUSION JUMP .....	22
K4 SPORT MONO .....	23
K4 SPORT DUAL .....	24
K3 SPORT JUMP .....	25
K2 JUMP .....	26
K2 GP .....	27

# Customisations Index

Every part of the Albion Saddle is crafted in our factory in Walsall, West Midlands.

At Albion, we believe that true precision in saddle making comes from considering both the horse and the rider. Our goal is to create a saddle that perfectly fits both. We take a holistic approach to saddle fitting, meaning there isn't a single component we can't adjust to suit the unique needs of each horse and rider pair.

## Why we consider the human anatomy when designing the saddle.

The rider's balance centers on the pelvis. Its position affects the rider's seat, leg placement, back function, and how they move with the horse. If the saddle does not support the rider's biomechanics, it disrupts the harmony with the horse, ultimately impacting the horse's movement.

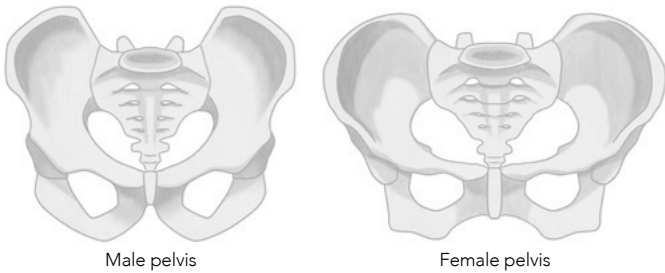

The seat of the saddle is crucial for rider development. We need to ensure the rider is balanced through the seat, with their weight evenly distributed across the panels. Our most recent research explored the rider's pelvic range in depth, demonstrating how a correctly positioned seat, tailored to the rider's pelvic range, allows for free movement in harmony with the horse.

## Why the rider's pelvis determines the choice of seat.

The morphology of the pelvis determines the choice of seat in two ways; **seat length** and **seat width**.

The positioning of the seat bones is conditioned by seat size, as indicated in the diagram. The smaller the saddle size, the closer the pelvis is to the pommel.

Therefore the size of the seat directly affects how the pelvis engages, which in turn influences the rider's positioning on the saddle.

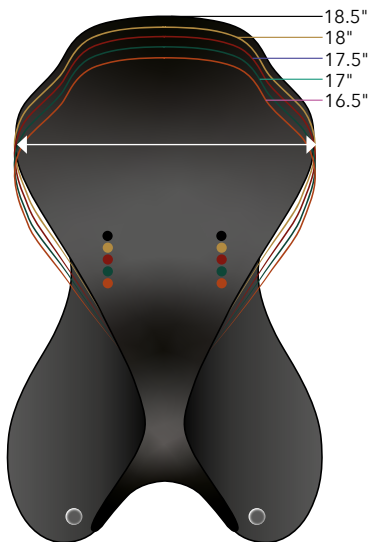

## CUSTOMISATION OPTIONS FOR THE RIDER

### Twist Profile.

With the addition of foam in the twist region, the twist profile can be adjusted in order to support the rider's pelvic range of movement.

**Narrow Twist** enables the pelvis to engage closer to the pommel and facilitates lateral leg opening.

**Wide Twist** provides support under the adductor muscle and facilitates leg opening.



### Seat Depth.

A rider may request a deeper seat when seeking a more secure feel from the saddle. This is achieved by building up the front of the saddle and placing a deeper cantle onto the saddle.



### Block Shape and Position.

Albion blocks are ergonomically designed to provide support to the rider as needed.

Our dressage range features blocks in various sizes and positions, to allow the rider to find the center of balance through their seat. In the jump range, the blocks support riders as their position shifts during take-off, flight, and landing over fences.

The block positioning has been developed over years of research and data collection, ensuring an "off-the-peg" fit for most riders. For those seeking a more customised fit, Albion offers bespoke block positioning to meet individual needs.

# Customisations Index

## TREES AND TEMPLATING

All Albion Trees are made in our factory in Walsall, West Midlands.

The Adjusta-Tree™ is specifically designed to be adjusted by any local Albion saddle fitter using pressure. This allows fitting modifications, using Albion approved pressure systems, without causing damage or distortion to the tree's head-plates or rivets, all while keeping the tree intact within the saddle.

The Adjusta-Tree™ is robustly engineered to withstand weight loading and pressure induced spread. It has been rigorously tested using Albion's own in-house mechanical spread testing equipment and further validated by an independent engineering laboratory with approved heavy load testing systems.

Albion's trees are precisely engineered to be accurate and symmetrical within a tolerance of +/-2mm, in compliance with the British Standard specification BS6635. Each tree undergoes strict quality control and is checked for accuracy and symmetry on a British Standard-approved engineer's inspection table before leaving the workshop.

Albion Precision Templating kit - what it is and why we use it.

Albion templating is essential to our commitment to saddle fitting precision. Not only does it provide us with valuable data for refining our saddle designs, but it's also crucial for ensuring a perfect fit for every horse.

Using the Albion Precision Templating Kit, we create a 2D representation of the horse's back on paper. This template allows us to accurately assess various aspects of the horse's conformation, including its shape, profile, and any areas of weakness. Once the template, along with supporting photos, is sent to our factory, we use it to recreate the horse's back profile on our in-house precision fitting horse.

This templating process is vital for building a custom saddle, ensuring the tree is perfectly tailored to your horse's unique shape and needs.

## FAST FACTS

- All Albion saddles are fitted with the Adjusta-Tree™
- The Albion tree warranty is 5 years for breakage while subject to normal usage and conditions
- All adjustments to Albion trees must be carried out by authorised persons and approved equipment only
- Adjusta-Tree™ is suitable for pressure machine adjustment by approved pressure systems
- Adjusta-Tree™ can be altered by 1 fitting up or down
- After two tree adjustments the rivets should be checked
- All other trees (pre 2014) must be returned to the Albion factory for adjustment

## Adjusta-Tree™ Anatomy

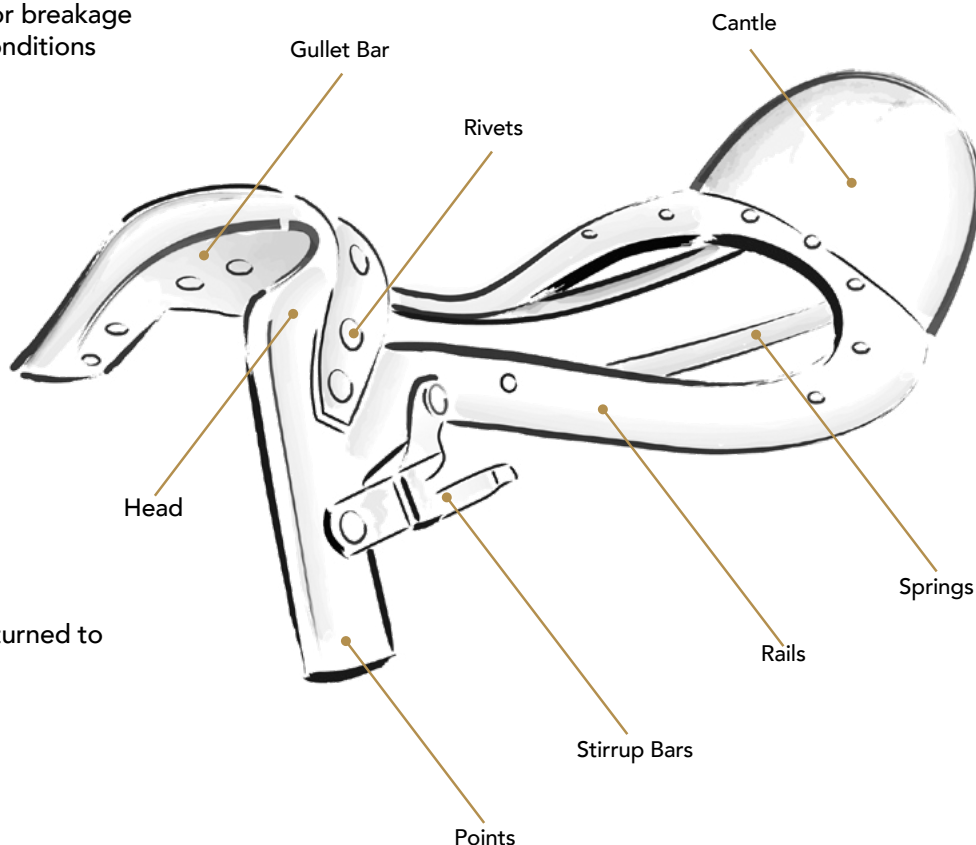



# Customisations Index

## CUSTOMISATION OPTIONS FOR THE HORSE

- Tree heads
- Head shape and additional customisation options
- Longitudinal options for the tree
- Short back panel customisation

### Tree Heads.

**Three** unique shapes of tree head (each adjustable in width) allow for unrivaled adaptation to the horse. Because of this, the horse fitting becomes independent of the rider fitting, ensuring optimum unity in practice.

The **V Tree**, previously known as the TB Tree, has a V-shaped head to adapt to angular horses and offers several arch openings.

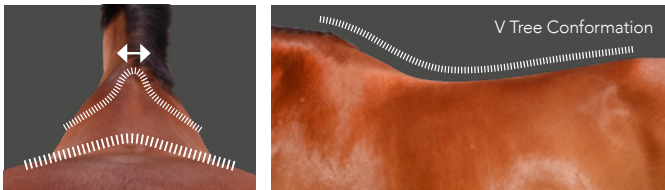

The **U Tree**, previously known as the WB Tree, features a U-shaped head designed for wider, more muscular horses. It offers several arch openings and is inspired by the design of the Platinum saddle tree. The U Tree incorporates an innovative feature that moves the bottom of the arch leg back by 1 cm, allowing even greater freedom of movement for the horse's shoulder.

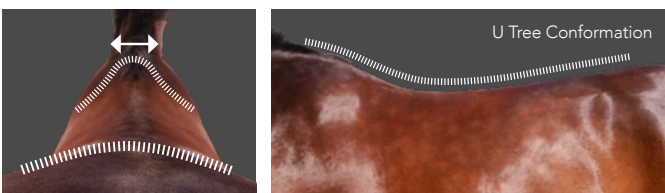

The **XU Tree**, formerly the CC, has an *Extra U-shaped* head which is more suited for Cob and Connemara breeds. It features shorter points and a curved tree as standard. Flat trees are available upon request.

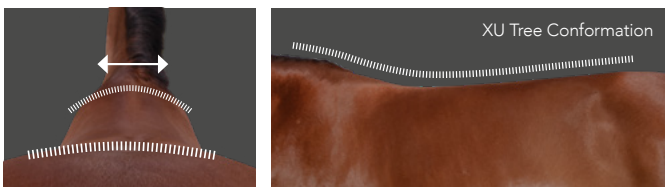

- Panel depth options
- Panel width customisation
- Girthing options
- Bolt in panel update

### Shape of Tree Heads & Additional Customisation Options.

#### V Tree for angular horses



**V Tree** as standard



**Flare Point Option:**

Slight opening to reduce pressure on shoulder muscles. Thin horses with well-developed muscles.



**High Head Option:**

For very high wither. Note: This option affects the rider's seat in two ways. It creates an X-Deep seat and a slightly shorter seat (compared to the regular).

#### U Tree for wide horses, large scapula



**U Tree** as standard



**Point Angle Option:**

Point angled back to allow for more shoulder movement.

#### XU Tree for very wide horses, native / pony types



**XU Tree** as standard



**Soft Tree Point Option:**

To improve the comfort on the scapula region for very wide horses.

# Customisations Index

## TREE HEADS AND CORRESPONDING MEASUREMENTS

Fitting system simplification.

We have streamlined the names and measurements of the arch openings across the three tree shapes to optimise the horse's fitting and to make our fitting system easier to understand. Now more linear and straightforward, it offers 16 possible shape x opening combinations, compared to the previous 10.

Our other tree-specific options, such as the Curve/ Flat tree, remain unchanged. Going forward, each of our saddles will incorporate these 16 arch options. Additionally, the integration of the U-tree into the SLK saddle, means that the Platinum saddle has been withdrawn from the range (these fitting options are now available in the SLK).

## DRESSAGE TREE HEAD MEASUREMENTS

Arch Opening	New Measurements	SHAPE OF TREE HEAD		
		V Shape	U Shape	XU Shape
N	275	X		
NM	285	X		
M	295	X		
MW	305	X		
W	315	X	X	X
XW	325	X	X	X
XXW	335		X	X
XXXW	345		X	X
XXXXW	355		X	X

## JUMP TREE HEAD MEASUREMENTS

Arch Opening	JUMP MODEL		
	K4 / Fusion	K2 / K3	K2 / K3
N	255	295	295
NM	265	310	310
M	275	325	325
MW	285	318	318
W	295	331	331
XW	305	344	344
XXW	315	357	357
XXXW	325	370	370
XXXXW	335	383	383

# Customisations Index

## CUSTOMISATION OPTIONS FOR THE HORSE

### Shape of Longitudinal Part of the Tree.

Available in two fitting solutions that follows the shape of the back between the withers and the lumbar region. This allows fitting for all types of conformation.



Curved Tree

**Curved Tree** features shaped rails to allow the tree to follow the contours of the horses back.



Flat Tree

**Flat Tree** is flat all the way through the rails. This allows the midsection of the tree to match the horse's widening profile and not in anyway dig in to them.

### Panel Depth Customisation.

The gusset depth is important depending on the conformation of the horse. The rear gusset may need to be increased if there is a larger true drop.

The panel may need to be made thinner or thicker along the tree line. This can be attributed to an under developed topline where atrophy is shown or may need to be slimmer on a wider horse. Both areas are important and subtle changes can be made through flocking.



#### V & U Tree:

3" Gusset as standard.  
 2.5" and 3.5" is an option.

#### XU Tree:

2.5" Gusset as standard with slim front gussets.  
 3" is an option.

### Short Back Panel Option.

Short back panels are standard in some models due to the modern day sport horse becoming shorter through breeding. The short back panels eliminate pressure directly behind the saddle, allowing freedom of movement for the horse over the back and loin area and in turn, maximised hock engagement. Panels can also come as standard or can be swept. A swept panel may be required when a horse has a sharp rise through their back from T18.



Short Back Panel

### Panel Width Customisation.

To increase the contact area, the panel width can be altered on all dressage models. This is particularly helpful in a more angular horse or where you may see atrophy. In some cases a drop panel may be required and can be ordered.



Wide Panel Option

# Customisations Index

## CUSTOMISATION OPTIONS FOR THE HORSE

### Girth Strap Options - Dressage.

A range of girthing options are available for the best fit for your horse.

Choose between 2 or 3 straps:

#### If 3 Straps:

This option consists of Point and Behind the Point, then a choice of back option, either V-Web or V-Web with Balance Strap.

#### If 2 Straps:

Choose a front option, either Point or Behind the Point. Then select a back option, either V-Web or V-Web with Balance Strap.

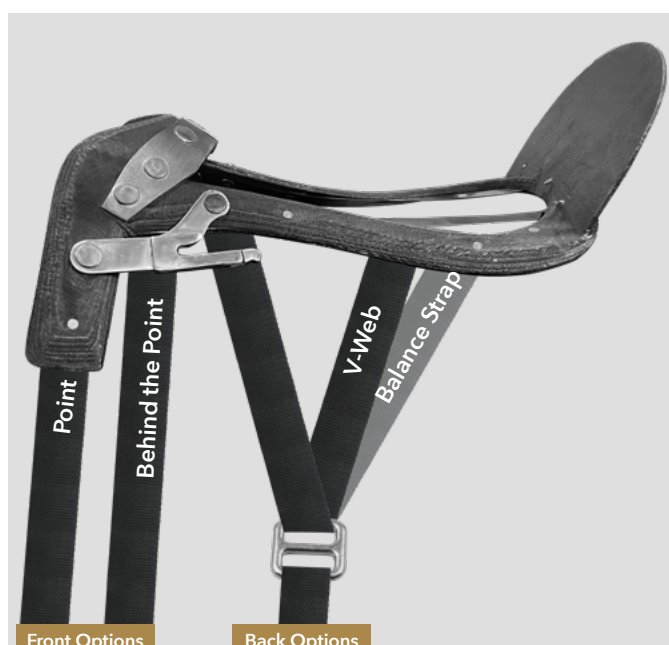

#### Point Strap:

The point strap can be used to secure the saddle if the saddle slips forward and may be used if girthing asymmetrically. This should not be used when girthing neutrally.

#### Neutral Girthing:

Neutral girthing uses the 'behind the point' and V Web.

#### Balance Strap:

The balance strap can be added to any of the dressage models as an option. This must be requested at the point of ordering the saddle.

### Girth Strap Options - Jump Mono-flap.

A range of girthing options are available for the best fit for your horse and the tree shape.





# Customisations Index

## CUSTOMISATION OPTIONS FOR THE HORSE

### Girth Strap Options - Jump Dual-flap.

A range of girthing options are available for the best fit for your horse and the tree shape.



### Girth Strap Notes - Jump

**Point Strap:**

This is a standard option on the U and XU models to aid with stability on the broader horses. We also offer spare webs to give fitters maximum girthing options for the best possible fit.

**Balance Strap:**

Only fitted as standard on the XU models but they can also be added to any of the jump models as an option. This must be requested at the point of ordering the saddle.

### Bolt In Panels.

All dressage saddles will now be made with a bolt in panel. This makes it easier for the fitter when adjusting the tree in the field. The fitter can drop the panels by unscrewing either the head nail, or the fall down and measure the tree points for accuracy. The panels below the points are secured with Velcro to enable the bolt in system. This is also helpful when fitting as it is easy to lift the flaps and see the panel bearing surface on the horse.



## DRESSAGE RANGE

### EVOLUTION OF THE DRESSAGE RANGE

The successful work carried out on the Unity by our master saddlers has opened up new possibilities for fitting the entire Albion dressage range to the rider-horse pair. The three tree-head shapes: the V-arch, U-arch, and the XU (formerly CC), will be integrated into the "master" saddles of our range: Fabrento, SLK, Revelation, Unity X, and Unity Y.

This evolution will allow all saddles in the dressage range to be customised to fit every horse's unique conformation. It also gives riders an unparalleled opportunity to select the most efficient seat for their biomechanics, ensuring a perfect fit for both horse and rider.

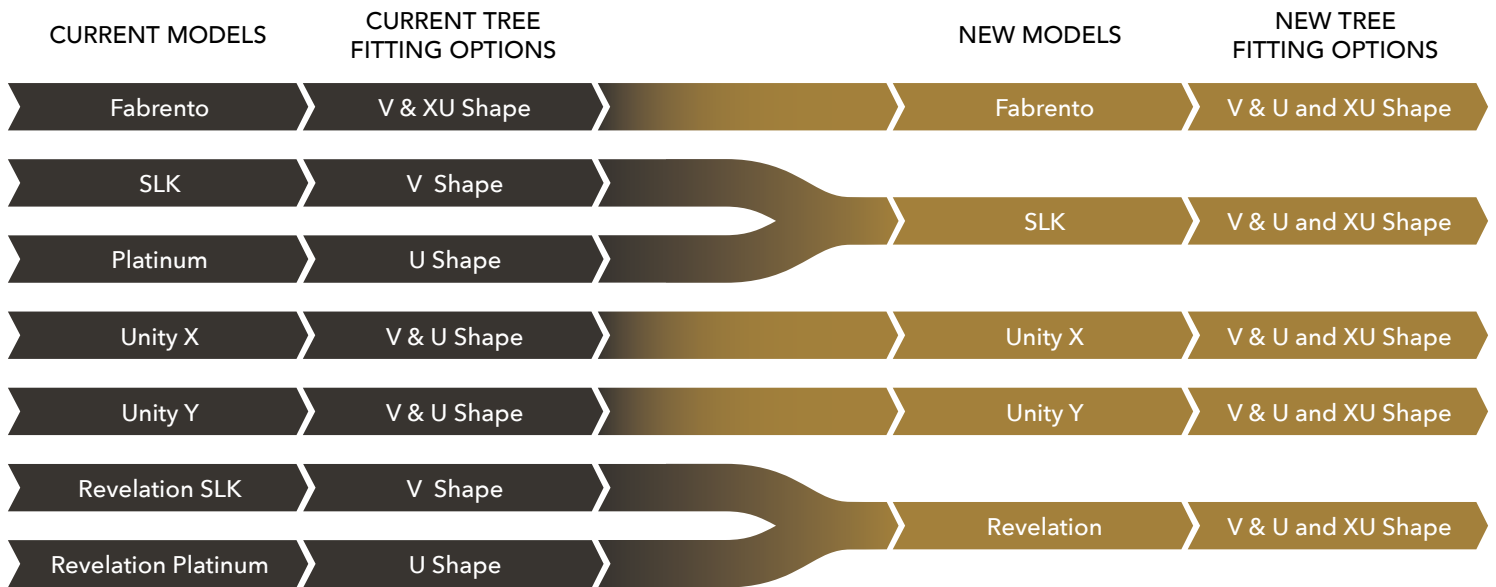

### SADDLE COMPARISONS



UNITY

Intermediate seat

Two types of seat depending on the model:

X seat: Wide twist. Opens the rider's leg setting them slightly back, encouraging an anterolateral leg position by moving the pelvis backwards.

Y seat: Narrow twist. Positioning the rider more over their feet. Suiting a smaller pelvis, e.g. male, allows lateral leg opening.

Supportive blocks but not restrictive

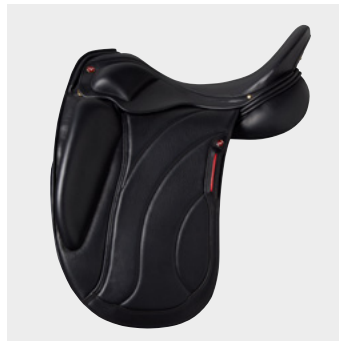

REVELATION

Deep seat

Support under the buttocks

Pelvis towards the pommel, upright position

Strong leg support from hip to knee



FABRENTO

Narrow seat, particularly suitable for smaller riders

Seat support under the buttocks

Pelvis towards the pommel, upright position

Supportive blocks but not restrictive

Lightweight saddle



SLK

Wide seat

Seat with a wide flat surface

Central pelvis position

Safe, deep saddle

# DRESSAGE RANGE



UNITY X & Y DRESSAGE

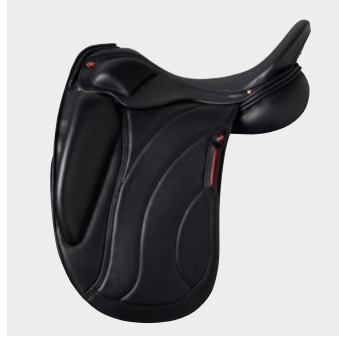

REVELATION RED LABEL DRESSAGE

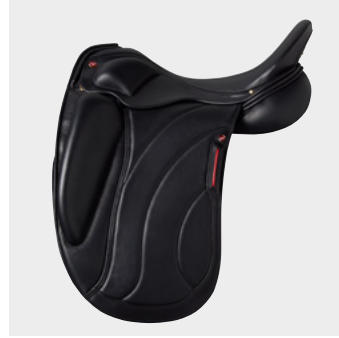

REVELATION COUTURE DRESSAGE



FABRENTO DRESSAGE (MONO)



SLK M3 ROYALE



SLK M3 (MONO)

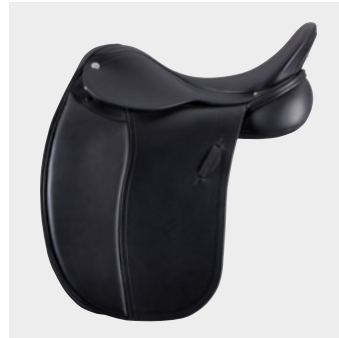

SLK M3 (DUAL)



K3 (MONO)



K2 DRESSAGE

FAST FACTS	UNITY	REVELATION RED LABEL	REVELATION COUTURE	FABRENTO	SLK	K2 / K3 DRESSAGE
Two seats profiles suited to the rider	✓					
V head shape	✓	✓	✓	✓	✓	
U head shape	✓	✓	✓	✓	✓	✓
XU head shape	✓	✓	✓	✓	✓	✓
Mono-flap	✓	✓	✓	✓	✓	✓ (K2)
Dual-flap					✓	✓ (K3)
Adjusta Tree	✓	✓	✓	✓	✓	✓
SBP	✓	✓	✓	✓	✓	
Template options	✓	✓	✓	✓	✓	✓
Customisation available	✓	✓	✓	✓	✓	✓
Close contact seat	✓	✓	✓	✓	✓	
Bolt in panels	✓			✓	✓	✓ (K3)
Moulded knee rolls for dual						



## UNITY (MONO) DRESSAGE

A series of saddles developed to enhance the rider's pelvic motion, resulting in the rider becoming more in sync with the horse's movement. A saddle uniting horse and rider.

The Unity Series is available in X and Y seat profiles plus V, U and XU trees for the ultimate in saddle fitting precision.

For the rider, there are two different seats correlating to two different morphologies.

X seat: wide twist, which opens up the rider's leg and sits them back slightly. It encourages the anterolateral opening of the leg by moving the pelvis backwards.

Y seat: narrow twist, allowing the rider to be more on top of their feet. Narrower seat, more suitable for a smaller pelvis like a man's, allowing the leg to be opened laterally.



### FAST FACTS

Head Shape:	V, U, XU
High Head:	Optional with V
Seat Size:	16.5", 17", 17.5", 18", 18.5"
Tree Profile:	Curved / Flat
Seat Shape:	Deep
Soft Seat:	Optional
Seat Width:	Narrow
Flap Length:	Standard, +1, +2, -1, -2
Flap Profile:	Straight
Block Position:	Fixed
Block Shape:	Unity
Block Sizes:	Standard, 1" Shorter
Girth Strapping:	Point, Behind the Point, V-Web
Panel contents:	Pure wool flocked with felt lined panel
Panel Length:	SBP
Panel Thickness:	Thick Front, Thick Back
Panel Depth:	3", 3.5". For the XU 2.5"
Colours:	Black and Brown
Materials:	Full grain calf leather



# REVELATION (MONO) DRESSAGE

The ultimate, fixed block, mono-flap dressage saddle.

The Revelation **RED LABEL** is crafted with precision in mind, offering V, U, and XU trees for the ultimate in saddle fitting accuracy.

The Revelation Red Label was designed as a standard fixed block saddle. Riders looking for a superbly comfortable, single flap, close contact saddle with a lightly supportive seat and leg positioning, enjoy the comfort and freedom of the Revelation Dressage saddles. The standard knee roll is soft and supportive and is fixed in one position on top of the flap.

For those desiring a bespoke touch, the Revelation is also available in the **COUTURE**. This option allows for customisable features such as block size and positioning. Riders can select from a variety of knee rolls, all fixed in a position tailored to their preferences, making it a truly personalised saddle experience.



## FAST FACTS

Head Shape:	V, U, XU
High Head:	N/A
Seat Size:	16.5", 17", 17.5", 18", 18.5"
Tree Profile:	Curved / Flat
Seat Shape:	Deep / Extra Deep
Soft Seat:	Optional
Seat Width:	Narrow
Flap Length:	Standard / +1 / +2 / -1 / -2
Flap Profile:	Straight
Block Position:	Fixed / Velcro. For Couture, Bespoke
Block Shape:	RL15. For Couture, Bespoke
Block Sizes:	Standard / 2" Shorter. For Couture, Bespoke
Girth Strapping:	Point, Behind the Point, V-Web
Panel contents:	Pure wool flocked with felt lined panel
Panel Length:	Regular / SBP as an option
Panel Thickness:	Thick Front, Thick Back
Panel Depth:	3", 3.5". For the XU 2.5"
Colours:	Black / Brown
Materials:	Full grain calf leather



## FABRENTO (MONO) DRESSAGE

Mono-flap dressage saddle for perfect 'feel'.

The FABRENTO is available with V, U and XU trees for the ultimate in saddle fitting precision.

Designed in response to the demand for a streamlined and sleeker looking saddle, the Fabrento offers an indulgently soft and well balanced close contact seat to ensure maximum stability and comfort, while encouraging a supportive yet non-restrictive leg position courtesy of exterior thigh blocks.

### FAST FACTS

Head Shape:	V, U, XU
High Head:	N/A
Seat Size:	16.5", 17", 17.5", 18", 18.5"
Tree Profile:	Curved / Flat
Seat Shape:	Deep
Soft Seat:	Optional
Seat Width:	Narrow
Flap Length:	Standard / +1 / +2 / -1 / -2
Flap Profile:	Straight
Block Position:	Fixed / Velcro
Block Shape:	R30
Block Sizes:	Standard / 2" Shorter
Girth Strapping:	Point, Behind the Point, V-Web
Panel contents:	Pure wool felt lining with wool stuffing
Panel Length:	SBP
Panel Thickness:	Thick Front, Thick Back
Panel Depth:	3", 3.5". For the XU 2.5"
Colours:	Black and Brown
Materials:	Full grain calf leather





## SLK M3 ROYALE (MONO) DRESSAGE

Deep, secure & supportive dressage saddle.

The SLK is available with V, U and XU trees for the ultimate in saddle fitting precision.

Riders looking for a deep, secure and supportive leg position love the SLK range, which is available in two comfortable seat widths, standard and narrow.

### FAST FACTS

Head Shape:	V, U, XU
High Head:	Optional with V
Seat Size:	16.5", 17", 17.5", 18", 18.5"
Tree Profile:	Curved / Flat
Seat Shape:	Deep
Soft Seat:	Optional
Seat Width:	Narrow
Flap Length:	Standard / +1 / +2 / -1 / -2
Flap Profile:	Straight
Block Position:	Fixed
Block Shape:	SLK
Block Sizes:	Standard
Girth Strapping:	Point, Behind the Point, V-Web
Panel contents:	Pure wool flocked with felt lined panel
Panel Length:	SBP
Panel Thickness:	Thick Front, Thick Back
Panel Depth:	3", 3.5". For the XU 2.5"
Colours:	Black / Brown
Materials:	Full grain calf leather







## SLK M3 (MONO) DRESSAGE

Deep, secure & supportive dressage saddle.

The SLK is available with V, U and XU trees for the ultimate in saddle fitting precision.

Riders looking for a deep, secure and supportive leg position love the SLK range, which is available in two comfortable seat widths, standard and narrow.



### FAST FACTS

Head Shape:	V, U, XU
High Head:	Optional with V
Seat Size:	16.5", 17", 17.5", 18", 18.5"
Tree Profile:	Curved / Flat
Seat Shape:	Deep
Soft Seat:	Optional
Seat Width:	Narrow
Flap Length:	Standard / +1 / +2 / -1 / -2
Flap Profile:	Straight
Block Position:	Fixed
Block Shape:	SLK
Block Sizes:	Standard
Girth Strapping:	Point, Behind the Point, V-Web
Panel contents:	Pure wool flocked with felt lined panel
Panel Length:	SBP
Panel Thickness:	Thick Front, Thick Back
Panel Depth:	3", 3.5". For the XU 2.5"
Colours:	Black / Brown
Materials:	Full grain leather





## SLK M3 (DUAL) DRESSAGE

Deep, secure & supportive dressage saddle.

The SLK is available with V, U and XU trees for the ultimate in saddle fitting precision.

Riders looking for a deep, secure and supportive leg position love the SLK range, which is available in two comfortable seat widths, standard and narrow.

### FAST FACTS

Head Shape:	V, U, XU
High Head:	Optional with V
Seat Size:	16.5", 17", 17.5", 18", 18.5"
Tree Profile:	Curved / Flat
Seat Shape:	Deep
Soft Seat:	Optional
Seat Width:	Narrow
Flap Length:	Standard / +1 / +2 / -1 / -2
Flap Profile:	Straight
Block Position:	Fixed / Velcro
Block Shape:	SLK
Block Sizes:	Standard
Girth Strapping:	Point, Behind the Point, V-Web
Panel contents:	Pure wool flocked with felt lined panel
Panel Length:	SBP
Panel Thickness:	Thick Front, Thick Back
Panel Depth:	3", 3.5". For the XU 2.5"
Colours:	Black / Brown
Materials:	Full grain leather





## K3 (MONO) DRESSAGE

Top Quality Introductory Dressage Saddle, mono (K3) or dual (K2) flap.

The K3 incorporates the popular K2 adjustable tree. Available in head shapes U and XU for the ultimate in saddle fitting precision.

The K3 Dressage has been designed for those riders looking for an introductory 'top quality' dressage saddle, with great comfort. Riders looking for a deep seat with a supportive leg position love the K2 Dressage. The standard knee rolls are soft, supportive and fixed in one position under the flap.

The K3 offers the same deep and supportive seat along with a close contact feel due to its mono-flap design, the knee rolls are supportive but non-restrictive, and fixed in one position.



### FAST FACTS

Head Shape:	U, XU
High Head:	N/A
Seat Size:	16.5", 17", 17.5", 18", 18.5"
Tree Profile:	Curved / Flat
Seat Shape:	Deep
Soft Seat:	Optional
Seat Width:	Regular
Flap Length:	Standard / +1 / +2 / -1 / -2
Flap Profile:	Straight
Block Position:	Fixed / Velcro. Pony: Velcro Std
Block Shape:	K2
Block Sizes:	Standard
Girth Strapping:	Point, Behind the Point, V-Web
Panel contents:	Pure wool flocked with felt lined panel
Panel Length:	Regular / SBP as an option (Adult)
Panel Thickness:	Thick Front, Thick Back
Panel Depth:	3", 3.5". For the XU 2.5"
Colours:	Black and Brown
Materials:	Full grain leather



## K2 (DUAL) DRESSAGE

Top Quality Introductory Dressage Saddle, mono (K3) or dual (K2) flap.

The K2 incorporates the popular K2 adjustable tree. Available in head shapes U and XU for the ultimate in saddle fitting precision.

The K2-K3 Dressage has been designed for those riders looking for an introductory 'top quality' dressage saddle, with great comfort. Riders looking for a deep seat with a supportive leg position love the K2 Dressage. The standard knee rolls are soft, supportive and fixed in one position under the flap.



### FAST FACTS

Head Shape:	U, XU
High Head:	N/A
Seat Size:	16.5", 17", 17.5", 18", 18.5"
Tree Profile:	Curved / Flat
Seat Shape:	Deep
Soft Seat:	Optional
Seat Width:	Regular
Flap Length:	Standard / +1 / +2 / -1 / -2
Flap Profile:	Straight
Block Position:	Fixed / Velcro. Pony: Velcro Std
Block Shape:	K2
Block Sizes:	Standard
Girth Strapping:	Point, Behind the Point, V-Web
Panel contents:	Pure wool flocked with felt lined panel
Panel Length:	Regular / SBP as an option (Adult)
Panel Thickness:	Thick Front, Thick Back
Panel Depth:	3", 3.5". For the XU 2.5"
Colours:	Black and Brown
Materials:	Full grain leather



# JUMP/GP RANGE





# JUMP/GP RANGE



FUSION JUMP (MONO)



K4 JUMP (MONO)



K4 JUMP (DUAL)



K3 JUMP (MONO) \*



K2 JUMP (DUAL) \*



K2 GP

FAST FACTS	FUSION	K4 SPORT MONO	K4 SPORT DUAL	K3 JUMP	K2 JUMP	K2 GP
Mono-flap	✓	✓		✓		
Dual-flap			✓		✓	✓
Adjusta Tree	✓	✓	✓	✓	✓	✓
Template options	✓	✓	✓	✓	✓	✓
Customisation available	✓	✓	✓	✓	✓	✓
Close contact seat	✓	✓	✓			
Bolted panels	✓					

\* Also Available in XU Fit

# FUSION (MONO) JUMP



Close contact jump saddle.

A high performance saddle with the closest contact ever achieved in a wool panel.

The refined weight bearing panels work in conjunction with the low profile seat, ensuring the correct balance of the saddle when in work.

The new flat seat allows the rider to engage with the horse and remain in close contact when faced with bigger and more challenging obstacles. The low cantle allows the rider to move within the saddle easily when required.

The saddle has been extensively researched and trialled with a wide cohort of riders varying in abilities. The unilateral feedback has been, closeness to the horse and security in the saddle.

## FAST FACTS

Seat Size:	16.5", 17", 17.5", 18", 18.5"
Tree Profile:	Curved / Flat
Seat Profile:	Flat
Soft Seat:	Optional
Flap Profile:	Straight, Extra Forward
Block Position:	Front: Velcro. Rear: Stitched
Block Sizes:	3 sizes included with the saddle
Girth Strapping:	Behind point & V-Web
Panel contents:	Pure wool flocked with felt lined panel
Panel Depth:	2.5" & 3"
Colours:	Black and Brown
Materials:	Full grain calf leather





## K4 SPORT (MONO) JUMP

High performance jump saddle.

Built on a V shaped tree to suit the modern competition horses. The K4 Jump Saddle builds on the success of Albion's best selling K3 and K2 Jump Saddles, with dual-flap and mono-flap designs that bring riders a range of benefits.

It boasts modern styling, with a super soft half deep seat and a pure wool flock and felt-lined panel to allow minor adjustments for an unrivalled fit. It has been created around three key pillars: comfort, security and stability.

### FAST FACTS

---

Seat Size:	16.5", 17", 17.5", 18", 18.5"
Tree Profile:	Curved / Flat
Seat Profile:	Semi flat
Soft Seat:	Optional
Flap Profile:	Straight, Extra Forward
Block Position:	Fixed
Block Sizes:	One
Girth Strapping:	Behind point & 2 straps on the middle
Panel contents:	Pure wool flocked with felt lined panel
Panel Depth:	2.5" & 3"
Colours:	Black and Brown
Materials:	Full grain calf leather





## K4 SPORT (DUAL) JUMP

High performance jump saddle.

Built on a V shaped tree to suit the modern competition horses. The K4 Jump Saddle builds on the success of Albion's best selling K3 and K2 Jump Saddles, with dual-flap and mono-flap designs that bring riders a range of benefits.

It boasts modern styling, with a super soft half deep seat and a pure wool flock and felt-lined panel to allow minor adjustments for an unrivalled fit. It has been created around three key pillars: comfort, security and stability.

### FAST FACTS

Seat Size:	16.5", 17", 17.5", 18", 18.5"
Tree Profile:	Curved / Flat
Seat Profile:	Semi flat
Soft Seat:	Optional
Flap Profile:	Straight, Extra Forward
Block Position:	Velcro
Block Sizes:	One
Girth Strapping:	Behind point & 2 straps on the middle
Panel contents:	Pure wool flocked with felt lined panel
Panel Depth:	2.5" & 3"
Colours:	Black and Brown
Materials:	Full grain calf leather







## K3 SPORT (MONO) JUMP

High performance mono-flap jump saddle.

The K3 Sport Jump builds on the success of Albion's best selling K2 Jump Saddle, with a mono-flap design that brings riders a range of benefits.

The mono-flap composition is a key element, with the single flap helping to create a closer contact and a lighter weight design.

It benefits from modern styling, a super soft half deep seat and a pure wool flock and felt-lined panel to allow minor adjustments for an unrivalled fit. It has been created around three key pillars: comfort, security and stability.

The K3 Sport Jump can be customised with coloured welts and more.



### FAST FACTS

Seat Size:	16.5", 17", 17.5", 18", 18.5"
Tree Profile:	Curved / Flat
Seat Profile:	Half Deep
Soft Seat:	Optional
Flap Profile:	Forward (1"), Extra Forward (2")
Block Position:	Fixed
Block Sizes:	One
Girth Strapping:	2 straps on middle web
Panel contents:	Pure wool flocked with felt lined panel
Panel Depth:	2.5", 3" & 3.5"
Colours:	Black and Brown
Materials:	Full grain leather





## K2 (DUAL) JUMP

Classic jump saddle.

The K2 Jump saddle is designed with a super soft seat and a supportive leg position for superior rider comfort. With a wide panel bearing surface and Adjusta-Tree™ technology specifically designed for adjustment using pressure by any local Albion saddle fitter, the K2 jump is as comfortable for the horse as it is for the rider.

The K2 Jump saddle is available in either full grain Ultima leathers with white stitching or traditional leathers giving comfort, style and durability.

### FAST FACTS

Seat Size:	16.5", 17", 17.5", 18", 18.5"
	Pony: 16", 16.5"
Tree Profile:	Curved / Flat
Seat Profile:	Half Deep
Soft Seat:	Optional
Flap Profile:	Forward, Extra Forward
Block Position:	Fixed / Velcro
Block Sizes:	One
Girth Strapping:	N, NM, M; behind points, 2 straps and back web. MW and wider; point, behind points and back strap
Panel contents:	Pure wool flocked with felt lined panel
Panel Depth:	2.5" (Standard), 3" & 3.5"
Colours:	Black, Dark Havana, Ultima Black, Ultima Brown
Materials:	Full grain leather or Ultima leather





## K2 GENERAL PURPOSE

Comfortable, all-purpose saddle.

The K2 GP has been designed for a comfortable, high quality, all-purpose saddle, suitable for jumping and showing.

Riders looking for a supportive seat and leg position love the K2 GP. The standard knee rolls are medium size, soft and supportive, fixed in one position under the flap. The K2 GP saddle has been designed with a super soft seat and a supportive leg position for superior rider comfort.



### FAST FACTS

<b>Seat Size:</b>	16.5", 17", 17.5", 18", 18.5"
<b>Tree Profile:</b>	Curved / Flat
<b>Seat Profile:</b>	Half Deep
<b>Soft Seat:</b>	Optional
<b>Flap Profile:</b>	Straight
<b>Block Position:</b>	Fixed / Velcro
<b>Block Sizes:</b>	Medium
<b>Girth Strapping:</b>	N, NM, M; behind points, 2 straps and back web. MW and wider; point, behind points and back strap
<b>Panel contents:</b>	Pure wool felt lining with wool stuffing
<b>Panel Depth:</b>	2.5" & 3"
<b>Colours:</b>	Black and Brown
<b>Materials:</b>	Full grain leather



*Est. 1985*

**ALBION**<sup>®</sup>  
SADDLEMAKERS

**Albion Saddlemakers Co. Ltd.**

Albion House, Bridgeman Street, Walsall, WS2 9PG England

T: +44 (0) 1922 646 210 | E: [sales@albionsaddlemakers.co.uk](mailto:sales@albionsaddlemakers.co.uk)  
[www.albionsaddlemakers.co.uk](http://www.albionsaddlemakers.co.uk)